

## LH-302FK WATER DETECTOR

### Packing List

Open the package and make sure that the device is in good condition and all the accessories are included as below.

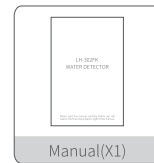
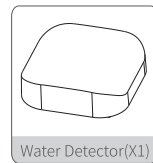

### Appearance & Feature

#### Appearance

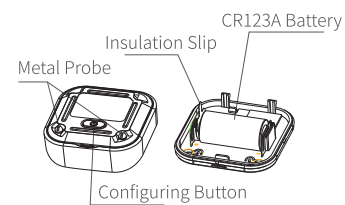

#### Feature

This product has an innovative double-sided design, a rotary opening design, and an IP66 waterproof rating, which guarantees normal use in humid and dusty environments, and has ultra-low power consumption, low-voltage

indication, and online reporting functions. It is widely used in banks, warehouses and home.

### Specification

Wireless Protocol	FSK
Transmit Frequency	868/433MHz
Transmitting Power	≤10dBm(433MHz) ≤13dBm(868MHz)
Working Voltage	DC3V(CR123A)
Quiescent Current	<30μA
Communication Distance	800m(Open Area)
Battery Life	5 year(10 times/day)
IP Class	IP66
Detection Water Level	0.5mm
Working Temperature	0°C~+55°C
Working Humidity	≤95%RH
Dimension	58*58*21mm

### Usage

#### Install "Secusystem" App

1. Scan the QR code below to download the "Secusystem" App.  
Or search for "Secusystem" in App Store or Google Play Store to download and install and create a new account.



iOS APP



Android APP

#### 2. Add Device

(1) Open the APP, add panel to the App according to the panel user guide.

(2) After the panel is successfully added, open the "Secusystem" App, click "Add", select "Add sub-device", scan for device QR code, and follow the prompts for subsequent operations.

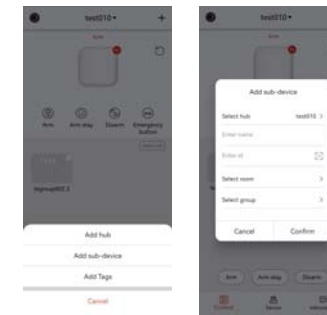

(3) Unscrew the two metal probes with a screwdriver and, through the clasp position, open the back cover and remove the battery insulation strips.

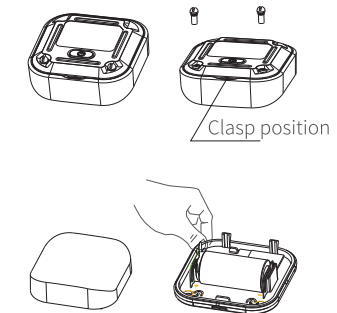

Please read this manual carefully before use. We reserve the final interpretation right of this manual.

(4) Press and hold down the device indicator light to put the sub-device into enrolling mode and the green light will flash quickly.

(5) Wait for the water detector to be added successfully, the panel will emit a "ding-dong" sound when it is successful. If the sub-device fails to be added, please retry the above steps.

#### Installation

The product probe is placed upwards in places to be monitored, such as windows, indoor or outdoor floors, or under the elbow of the water pipe. If there is water leakage, the sensor will send an alarm signal to the panel.

#### Notice

The product needs to have the screws tightened after changing the batteries, if they are not tightened there is a possibility of water leakage, resulting in damage to the product circuit.

#### Function Instruction

1. This product needs to be used with panel. When using the product for the first time or replacing the panel, it needs to be connected with the panel.

2. This product has a low voltage reminder function. When the product battery voltage is low, the water detector will send a low voltage reminder to the panel.

#### Warranty

Dear customer:  
Thank you for choosing the equipment. Please read the instruction carefully before installation:

1. Our guarantee time is one year from the date you bought. Under the condition of correct operation following the manual, if fault happens during the warranty period, we will repair for free. If fault happens in seven days, we can change for you for free.

2. The following conditions are not covered by the warranty. We will charge the repair if there are below conditions during warranty period:

- The false caused by wrong operation or using environment..
- The other faults that are not caused by our design, technology, quality and manufacturing.
- Fault caused by working with the third party products, software and so on.
- Improper installation, misuse, unauthorized repair, modification, accident, force majeure event or other external cause of failure or defect.

#### Caution

- There's risk of explosion if the battery is replaced by an incorrect type;
- Disposal of a battery into fire or a hot oven, or mechanically crushing or cutting of a battery, that can result in an explosion;
- Leaving a battery in an extremely high temperature surrounding environment that can result in an explosion or the leakage of flammable liquid or gas;
- A battery subjected to extremely low air pressure that may result in an explosion or the leakage of flammable liquid or gas.

#### Warning

- Do not ingest battery;
- This product contains a battery. If the battery is swallowed, it can cause severe internal burns in just 2 hours and can lead to death;
- Keep new and used batteries away from children; If the battery compartment does not close securely, stop the product and keep it away from children;
- If you think batteries might have been swallowed or placed inside any part of body, please seek immediate medical attention.